

# CozyWorks Floor Plan Layout (1300 sq ft) - Revised

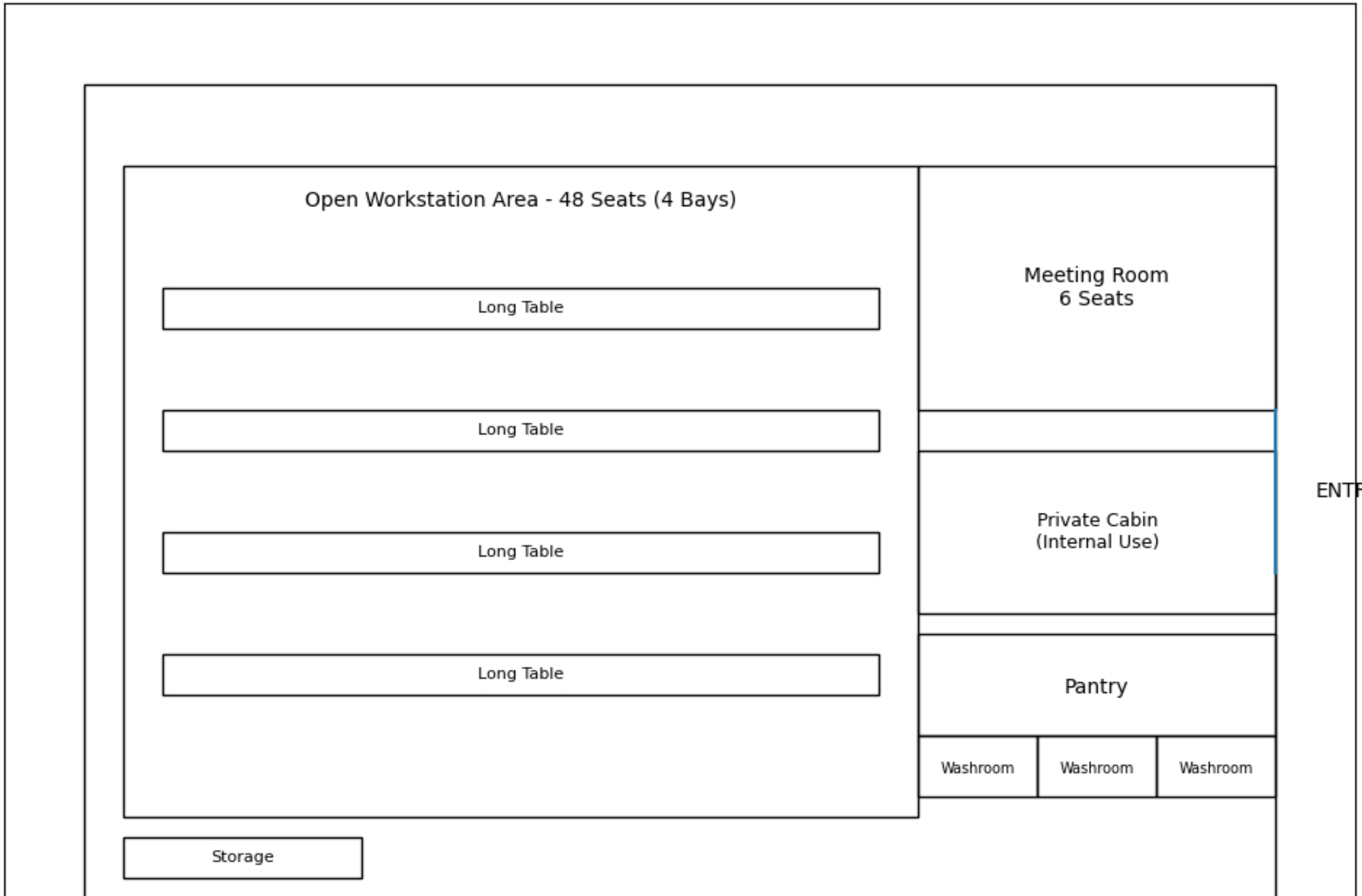

Open Workstation Area - 48 Seats (4 Bays)

Long Table

Long Table

Long Table

Long Table

Storage

Meeting Room  
6 Seats

Private Cabin  
(Internal Use)

Pantry

Washroom

Washroom

Washroom

ENTRY